



STARHOTELS®

PREMIUM

---

Du Parc

PARMA



# Du Parc

PARMA



## *Art Nouveau Elegance*

The Starhotels Du Parc, an elegant hotel that still retains its original façade and exquisite Art Nouveau interiors, stands in the centre of Parma, beside the lush greenery of Parco Ducale. It welcomes guests in its 169 spacious rooms and suites, provided with every comfort and enriched by refined decorative details.

# Du Parc

PARMA

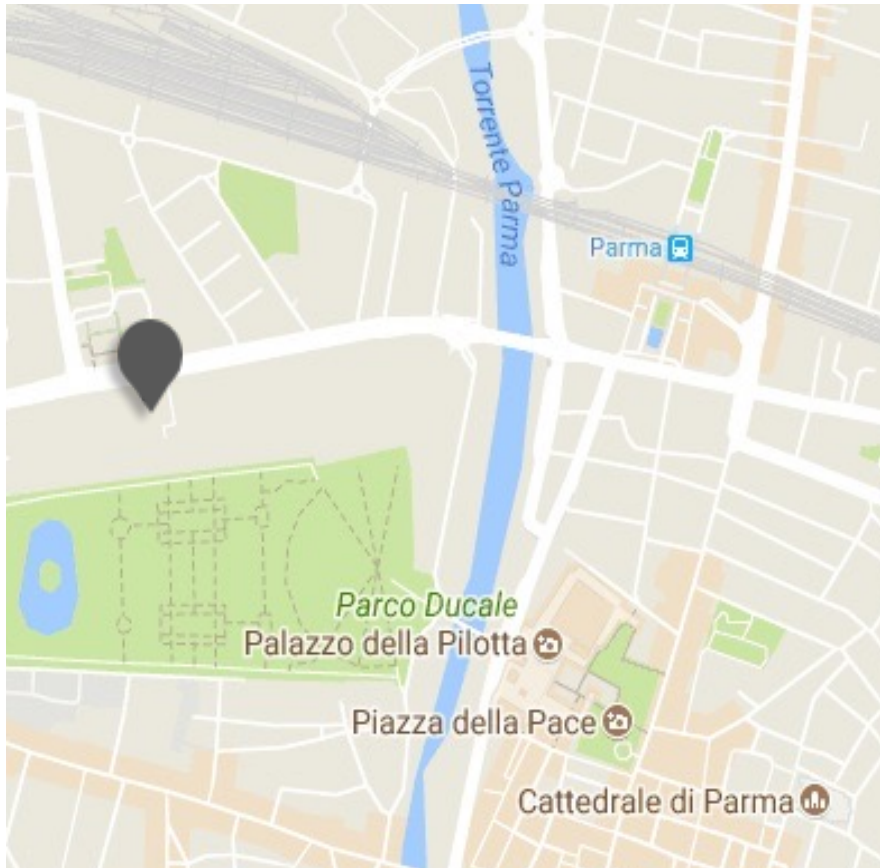

## Location

Within easy reach of the station and only 4 kilometres from the Exhibition Centre. A small bridge links it to the magnificent Parco Ducale and the historic centre

## Distances

**Railway station:** Km 0,5

**Highway:** Km 3

**Airport:** Giuseppe Verdi Km 5

**Fairgrounds:** Km 4

Viale Piacenza, 12/c - 43100 Parma - ITALY

T +39 0521 292929 F +39 0521 292828

[duparc.pr@starhotels.it](mailto:duparc.pr@starhotels.it)

[starhotels.com](http://starhotels.com)



# Du Parc

PARMA

## Restaurant & Bar

The Canova by Eataly restaurant's is a wonderful setting to enjoy local and international dishes, while the neighbouring Aiglou and Parmigianino rooms can host up to 200 guests for banquets and large events.

The elegant Canova by Eataly bar is the ideal venue for a superb coffee, a light lunch or a cocktail.





# Du Parc

PARMA



## 169 Rooms

- 52 Classic
- 30 Superior
- 67 Deluxe
- 6 Junior Suite
- 8 Junior Suite Deluxe
- 6 Suite

Each of the 169 rooms has its own distinctive style and an attractive touch of Art Nouveau flair created by refined furnishings, sumptuous brocades, tapestries and beautiful fabrics in warm colours.





# Du Parc

PARMA



## Meetings & Events

**Meeting rooms: 9**

**Capacity (theatre style): 550 max**

The hotel offers 9 bright, versatile meeting rooms can host up to 550 participants and are equipped with high-tech conference facilities. A team of professionals is at guests' disposal to handle any type of event with great skill and attention to detail.



# Du Parc

PARMA

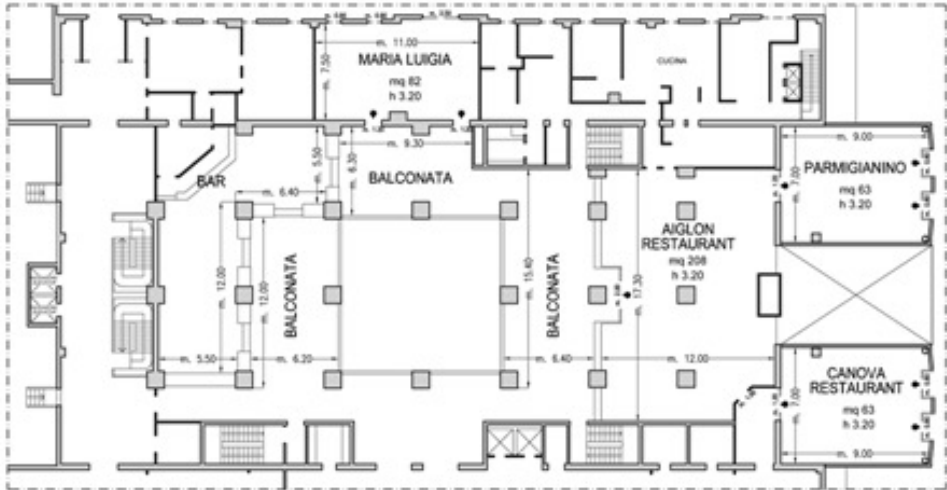

Piano Terra / Ground Floor



Piano -1 / Basement

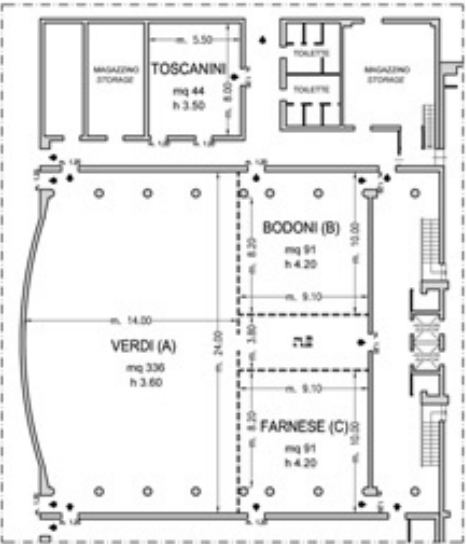

Piano -2 / Floor -2

- ◆ Uscite di sicurezza / Emergency Exits
- Finestre / Windows
- ==== Paredi mobili / Modular Walls
- Colonne / Columns

# Du Parc

PARMA

Meeting rooms	Area mq / ft.	L x W mt. / ft.	Height mt. / ft.	Theatre	Class room	Conference table/ U-shape	Cabaret style^	Cocktail reception	Banquet
Verdi (A)	336 3615,36	14,00x24,00 45,93x78,74	3,6 11,81	300	120	75	108	350	250
Bodoni (B)	91 979,16	10,00x9,10 32,81x29,86	4,2 13,78	70	40	30	24	90	40
Farnese (C)	91 979,16	10,00x9,10 32,81x29,86	4,2 13,78	70	40	30	24	90	40
(A+B+C)	564 6070,82	23,50x24,00 77,10x78,74	3,60-4,20 11,81-13,78	550	250	140	210	500	450
Toscanini	44 473,44	8,00x5,50 26,25x18,04	3,5 11,48	35	10	15	12	-	-
Maria Luigia°	82 882,32	11,00x7,50 36,09x24,61	3,2 10,5	45	25	20	24	50	-
Stendhal°	60 645,83	6,50x9,20 21,33x30,18	2,7 8,86	35	18	18	12	-	-
Rossini°	76 818,05	12,80x6,00 41,99x19,68	2,7 8,86	45	25	20	18	50	-
Puccini°	84 904,16	14,00x6,00 45,93x19,68	2,7 8,86	65	30	25	24	-	-
Donizetti	46 494,96	8,50x5,50 27,89x18,04	2,7 8,86	35	15	15	12	-	-
Foyer Congressi	120 1291,2	10,00x12,00 32,81x39,37	-	-	-	-	-	120	-
La Piazzetta	115 1237,84	10,50x11,00 34,44x36,08	-	-	-	-	-	110	-
Aiglon + Parmigianino Canova by Eataly + Balconate	570 6135,4	22,00x26,00 72,18x85,30	-	-	-	-	-	-	-
Canova by Eataly Restaurant °	63 677,88	7,00x9,00 22,97x29,53	-	-	-	-	-	-	50
Aiglon room	208 2238,92	17,30x12,00 56,74x39,36	-	-	-	-	-	250	180
Parmigianino	63 677,88	7,00x9,00 22,97x29,53	-	-	-	-	-	-	50

° Daylight

^ Cabaret style: Diameter tables cm 180, up to 6 pax each