

STARHOTELS®

Business Palace

MILANO



An icon of industry transformed into a landmark of luxury. The Business Palace is set inside a converted early 1900s factory and its spacious rooms are perfectly suited to large events and conferences. As its name suggests, the hotel is a favorite with business travelers thanks to its excellent transport links, flexible meeting spaces and quiet rooms. It also excels when it comes to relaxation, with a renowned restaurant and fitness room with panoramic views across Milano.

Via Gaggia, 3
20139 Milano - ITALY
T +39 02 535451
F +39 02 57307550
business.mi@starhotels.it
starhotels.com

Rooms & Suites

Elegant and comfortable with hi-tech details, our 247 rooms and suites create a home-away-from-home for business and leisure travelers alike.

Restaurant & Bar

From sophisticated dining to welcoming buffets and relaxing drinks, our restaurant Borromeo and our lively bar will fulfil every wish.

Services

We offer thoughtful services throughout your stay – from secure parking to Wi-Fi, a fitness center, a peaceful library and courtyard.

Meetings & Events

12 outstanding meeting rooms for up to 340 people and an experienced Events Manager will help deliver your event with style.







Location

The Business Palace hotel is located in Milan's east business district near to Rogoredo train station for connections to Malpensa and Linate airports. If you're here on holiday we're also just a short stroll from metro links to central Milan. Discover must-see sights like the Duomo and seek out world-class culture at La Scala Theater. View famous artistic treasures at The Palazzo Reale or browse through the fashionable boutiques of Corso Como, Via della Spiga e via Montenapoleone.

From the station

- From the Milano Centrale Train Station (10km), take metro line 3 to the Porto di Mare stop (10 metro stops).
- From the Milano Rogoredo Train Station (800 meters) you can either walk to the hotel or take the metro line 3 for one stop to Porto di Mare (1 metro stop).

From the highway

- From the A1 Milano/Roma highway take the Tangenziale Est (East bypass road) to the Piazzale Corvetto exit (500m).
- From the A4 Milano/Venezia highway, coming from Venezia, take the Tangenziale Est (East bypass road) to the Rogoredo exit (500m); coming from Torino take the Tangenziale Ovest (West bypass road) to the Piazzale Corvetto exit (500m).

From Milano airports

- From Linate Airport (3 km): Forlanini Avenue -Ovidio Square-Lombroso Street-Varsavia Street (underpass)-Toffetti Street-Pietro Gaggia Street
- From Malpensa Airport (45 km): take Tangenziale Ovest to Piazzale Corvetto exit (mt 500) or take "Trenord" train to Rogoredo station (change at Bovisa train stop).
- From Orio al Serio airport (45 km): take Tangenziale Est; Piazzale Corvetto exit (mt 500)

From the fiera

- From the Fiera (8km), at the Amendola Fiera stop take metro line 1 to the Duomo stop, then take line 3 to the Porto di Mare stop.
- From the New Fiera Complex (20km), at the Rho Fiera Milano take Line 1 (red Line) to the Duomo stop, then take line 3 to the Porto di Mare stop.

Public transport underground

- Line 3 (the Yellow line -Porto di Mare Station: 20 m)
- Bus: 95 (direct to S.Siro Football Stadium 84: down town Both around the corner.



12 meeting rooms

All meeting rooms are equipped with: Wi-Fi (at a charge), sound system, screen, LCD projector⁽¹⁾, flip chart, other services are available upon request.

⁽¹⁾Max one LCD projector complimentary, additional requests at a charge



Meeting rooms	Area sq.ft.	L x W ft.	height ft.	theatre	class room	conference table/ U-shape	cabaret style [^]	cocktail reception	banquet
Viscontea (A)	1646,28	43,67x37,83	12,66-15,09	150	72	37	44	140	88
Viscontea (B)	1269,68	43,67x29,17	12,66-15,09	117	72	37	32	100	64
Viscontea (A+B)	2937,48	67,22x43,67	12,66-15,09	340	180	55	76	220	152
Sforzesca (A)	979,16	32,32x30,45	8,86-10,27	78	42	25	20	80	40
Sforzesca (B)	979,16	32,32x30,22	10,27	78	42	25	20	80	40
Sforzesca (C)	473,44	29,63x15,98	10,27	38	24	15	8	30	16
Sforzesca (A+C)	1506,4	32,32x46,52	10,27	114	54	31	28	120	56
Sforzesca (B+C)	1506,4	32,32x46,52	10,27	114	54	31	28	120	56
Sforzesca (A+B+C)	2496,32	32,32x77,30	10,27	220	150	40	48	190	96
Torriana	763,96	20,83x36,71	10,27	79	36	26	24	60	48
Gonzaga	667,12	20,90x31,73	10,27	57	30	23	24	50	48
Ambrosiana	634,84	20,41x31,07	10,27	47	30	22	16	45	32
Braidense	591,8	20,41x29,23	10,27	45	30	22	16	40	32
Meneghina (A)	301,28	20,37x14,89	10,27	24	10	14	4	16	8
Meneghina (B) [°]	290,52	20,08x14,44	12,3	-	-	6	-	-	-
Meneghina (C)	269,10	13,64x20,32	9,64	12	-	12	-	-	-
N. 19 Studio Suite [°]	215,20-269	17,65x12,14	8,86	-	-	14	-	-	-
Foyer	5778,12	173,88x20,34 + 76,77x29,52	10,27	-	-	-	-	-	-
Garden / reception and exhibition area	5874,96	173,88x20,34	-	-	-	-	-	-	-
Borromeo Restaurant	5326,2	42,09x126,71	10,27	-	-	-	-	350	280

[°] Daylight

[^] Cabaret style: Diameter tables cm 160, up to 5 pax each

STARHOTELS®

Business Palace

MILANO

Via Gaggia, 3

20139 Milano - ITALY

T +39 02 535451 - F +39 02 57307550

meeting.business.mi@starhotels.it starhotels.com

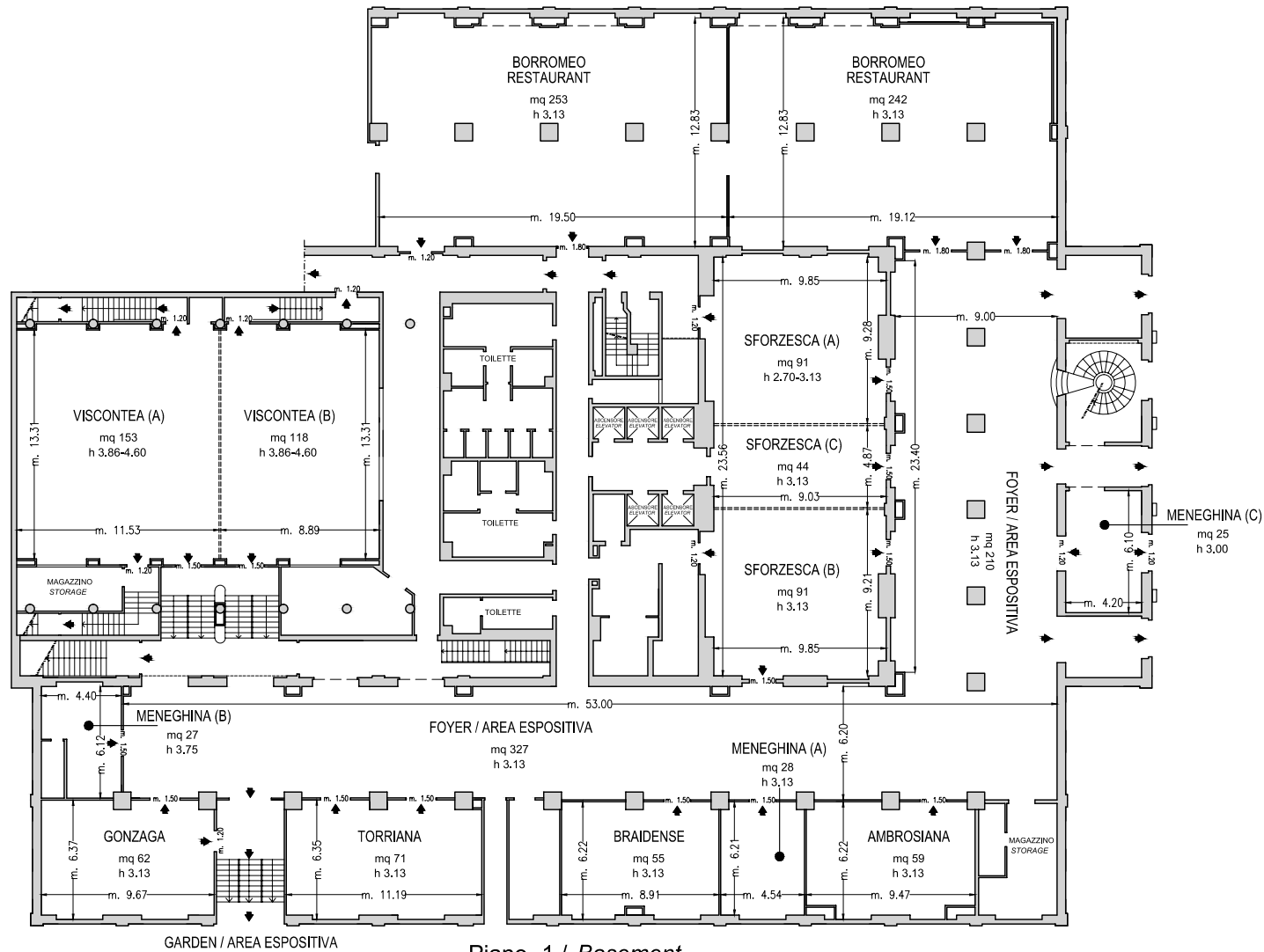

Piano -1 / Basement

12 meeting room fino a 340 persone/ 12 meeting rooms up to 340 seats

➤ Uscite di sicurezza / Emergency Exits

- - - - Finestre / Windows

===== Paredi mobili / Modular Walls

□ Colonne / Columns