

The image shows a sophisticated lounge area with deep red leather armchairs and sofas arranged around dark wood tables. Spherical pendant lights hang from the ceiling, casting a warm glow. The walls are a mix of dark wood and light-colored panels. In the foreground, a bottle of champagne is chilling in a silver bucket on a wooden table.

STARHOTELS®

Ritz
MILANO

Standing in a quiet street just behind the glittering shops and theatres of Corso Buenos Aires, the Ritz is the definition of Milanese cool. Recently refurbished, this boutique hotel perfectly captures the spirit of Milano: bold, contemporary features and opulent fabrics and furnishings, along with panoramic photographs in each room. To relax, there's a peaceful wellness area with fitness room, Turkish bath and sauna – an indulgent space to unwind after a thrilling day in the city.

Via Spallanzani, 40
20129 Milano - ITALY
T +39 02 20551
F +39 02 29518679
ritz.mi@starhotels.it
starhotels.com



Rooms & Suites

Our 197 rooms and suites are thoughtfully designed with style and comfort in mind – some offer stunning views across Milano.

Restaurant & Bar

The hotel's restaurant and outside lounge offers you a welcoming atmosphere to savor the best of international or local cuisine, stunning winelists and delicious cocktails.

Services

Carefully tailored to ensure you have a blissful stay – from room service and laundry to Wi-Fi and a fitness center with a Turkish bath and sauna.

Meetings & Events

Seven modern meeting rooms for up to 170 people and an experienced Events Manager will help you deliver an outstanding event.



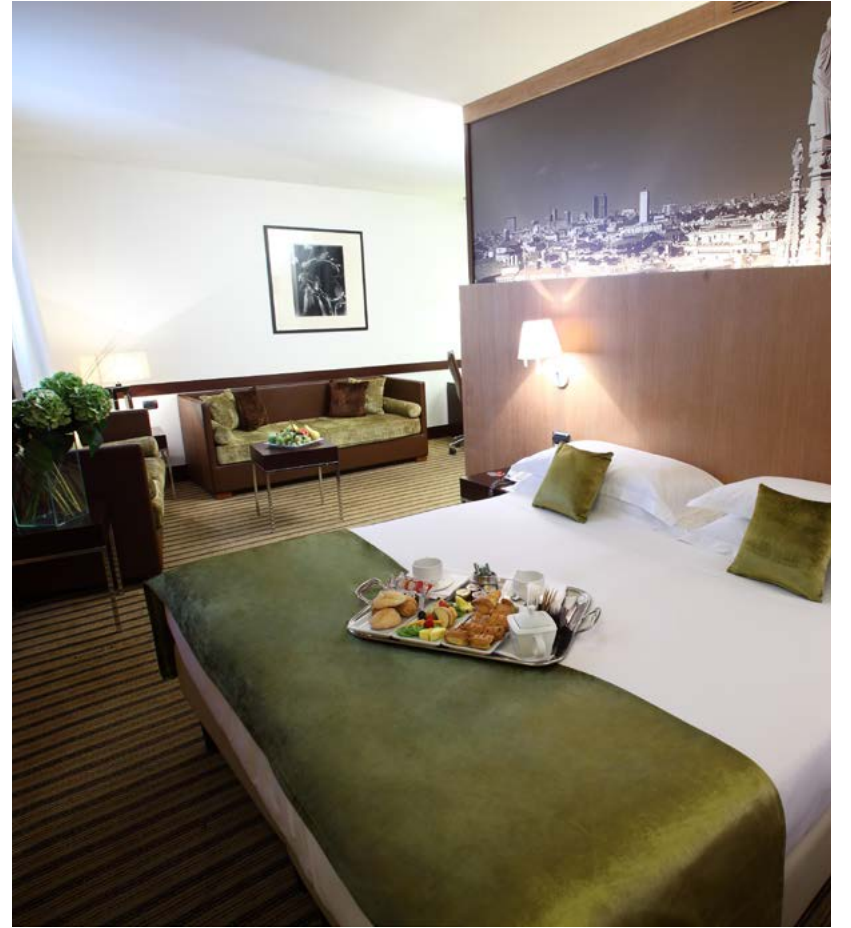



Location

Fashion, culture, business – connect with them all from the Ritz. Standing on a quiet street just behind the thriving Corso Buenos Aires and near the Centrale railway station, our hotel puts both the financial district and the city's historic heart within easy reach. A short walk will take you to famous attractions like the Duomo or the Museo Poldi Pezzoli, or to the boutiques of the world-renowned fashion district.



From the station

- From the Milano Centrale train station (1 km) take the tram towards Lambrate or towards the Duomo to the Lima stop.
- On the Metro, take the green line towards Gobba to the Loreto stop and then the red line towards Molino Dorino/Bisceglie to the Lima stop.

From the highway

- From A1 Milano/Roma highway and A4 Milano/Venezia highway (4 km), exit Palmanova and go towards the city centre.

From the airport

- From Linate Airport (10km), take bus towards San Babila, then the metro, red line, towards Sesto FS to the Lima stop.
- From Malpensa Airport (60km), Malpensa Express to the Cadorna Station, then the metro to the Lima stop.
- From Orio al Serio Airport (50km) take the bus to Milano Centrale Train Station. Next, take the underground green line towards Gobba to the Loreto stop and then red line towards Molino Dorino/Bisceglie to the Lima stop.

From the Fiera (Fairgrounds)

- From the New Fiera Complex (12km), take the underground line 1 to the Lima stop.



7 meeting rooms

All meeting rooms are equipped with: Wi-Fi (at a charge), sound system, screen, LCD projector⁽¹⁾, flip chart, other services are available upon request.

⁽¹⁾Max one LCD projector complimentary, additional requests at a charge



Meeting rooms	Area mq / ft.	L x W mt. / ft.	Height mt. / ft.	Theatre	Class room	Conference table/ U-shape	Cabaret style [^]	Cocktail reception	Banquet
Venezia (A)	107 1151,32	11,00x9,30 36,09x30,51	2,8 9,19	80	50	34	50	100	60
Venezia (B)	63 677,88	6,80x9,30 22,31x30,51	2,8 9,19	40	30	18	16	40	40
Venezia (A+B)	170 1829,2	17,90x9,30 58,73x30,51	2,8 9,19	170	80	50	66	160	100
Vittoria (A)	76 817,76	8,30x9,10 27,23x29,86	2,8 9,19	50	30	28	16	50	50
Vittoria (B)	94 1011,44	10,40x9,10 34,12x29,86	2,8 9,19	80	50	34	50	100	60
Vittoria (A+B)	170 1829,2	20,50x9,10 67,26x29,86	2,8 9,19	170	80	60	66	150	100
Gottardo	66 710,44	13,70x4,90 44,95x16,08	2,7 8,85	50	30	20	15	50	30
Monforte (A) [°]	87 936,5	13,00x6,70 44,95x22,00	2,90-3,30 9,51-10,82	75	50	30	32	90	60
Monforte (B) [°]	73 785,8	11,00x6,70 36,10x22,00	2,90-3,30 9,51-10,82	60	40	22	32	70	40
Monforte (A+B) [°]	160 1722,28	24,20x6,70 79,40x22,00	2,90-3,30 9,51-10,82	160	80	55	64	160	100
N° 4 Studio Junior Suite	28 301,39	6x4 19,67x13,12	2,95 9,67	-	-	12	-	-	-
Foyer	180 1937,5	34x5,50 111,5x18,05	2,2 7,2	-	-	-	-	-	-
Bruscherteria Restaurant (A)	105 1130,24	11,40x8,90 37,40x29,20	2,7 8,85	-	-	-	-	-	26
Bruscherteria Restaurant (B)	110 1184,06	13,10x8,65 42,98x28,38	2,90-3,30 9,51-10,82	-	-	-	-	-	80
Bruscherteria Restaurant (A+B)	215 2314,3	24,50x8,90 80,38x29,20	2,7 8,85	-	-	-	-	150	106
Garden / reception and restaurant area	220 2368,13	19x14,20 62,31x46,57	-	-	-	-	-	50	-

[°] Daylight

[^] Cabaret style: Diameter tables cm 180, up to 8 pax each

STARHOTELS®

Ritz
MILANO

Via Spallanzani, 40
20129 Milano - ITALY
T +39 02 20551 - F +39 02 29518679
meeting.ritz.mi@starhotels.it starhotels.com

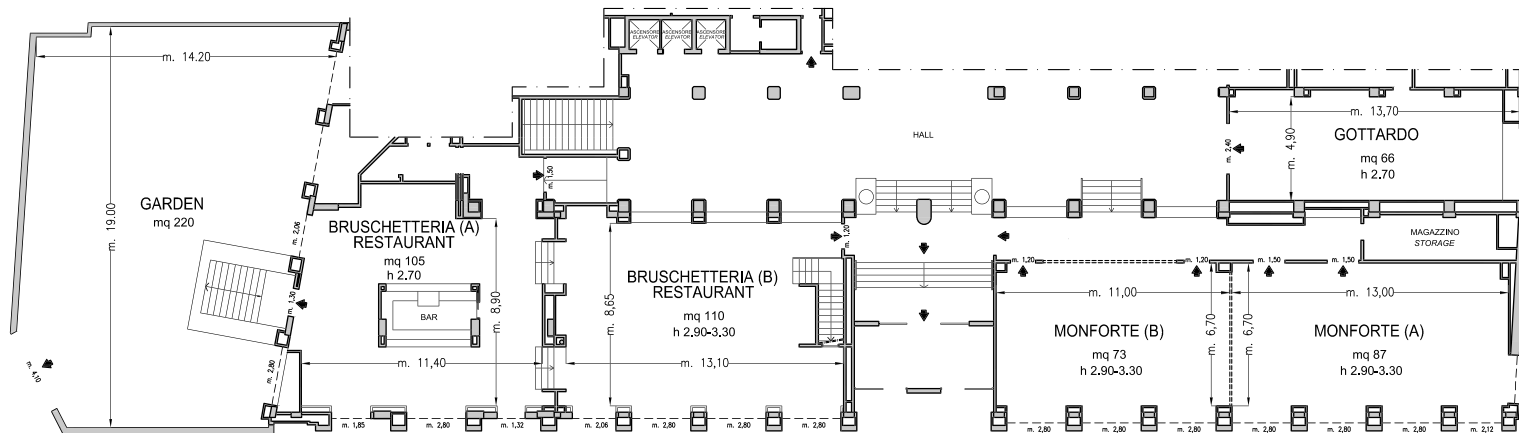

Piano Terra / Ground Floor

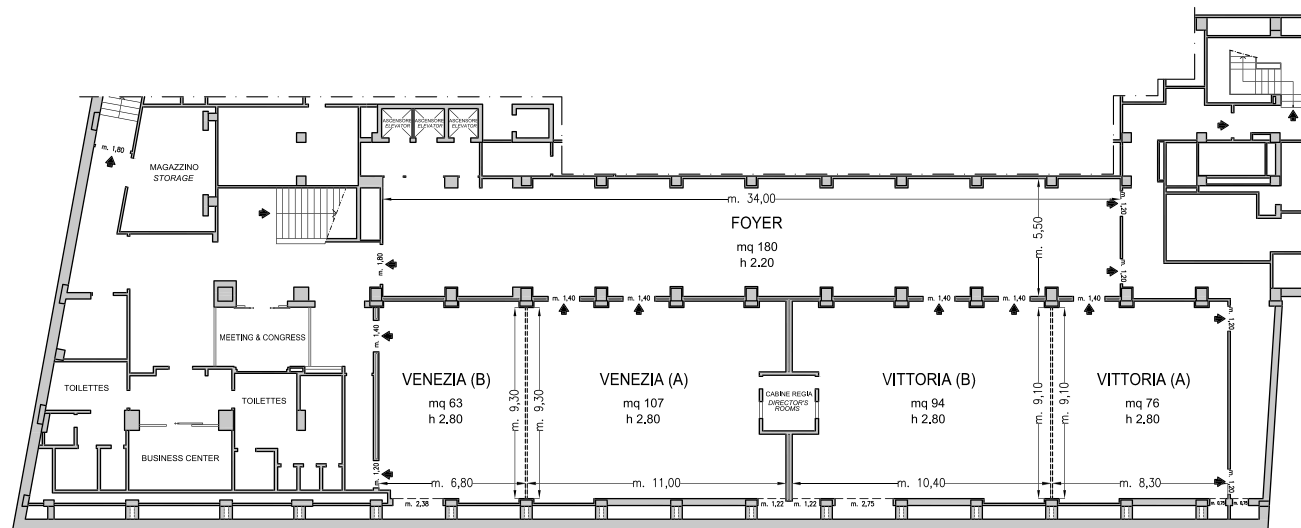

Piano -1 / Basement

- Uscite di sicurezza / Emergency Exits
- Finestre / Windows
- ⋯⋯⋯ Pareti mobili / Modular Walls
- Colonne / Columns

7 meeting room fino a 170 persone/ 7 meeting rooms up to 170 seats

STARHOTELS®

Ritz
MILANO

Via Spallanzani, 40
20129 Milano - ITALY
T +39 02 20551 - F +39 02 29518679
meeting.ritz.mi@starhotels.it starhotels.com